

Liftman

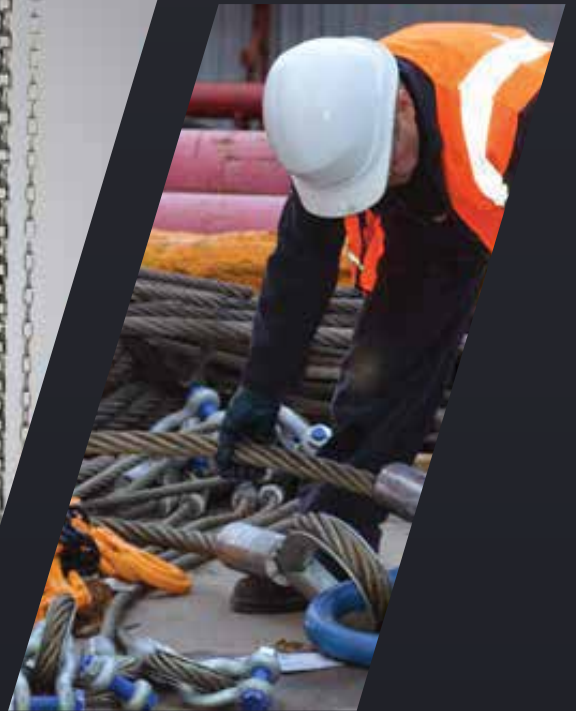

LIFTING SPECIALISTS

www.liftmanuk.com



INTRODUCTION

We have firmly established ourselves as specialist and suppliers of a full integrated range of lifting and pulling equipment. Our products are manufactured under strict quality control confirming to the stringent requirements of the lifting industry. The products are inspected and tested in line with the international standards. This ensures quality products supplied to our customers globally.

The products are certified to EN standards with complete traceability from manufacturer to usage is available. We hold substantial stocks to enable us take care of urgent requirements.

Our Vision

To be a leading supplier of lifting equipment's for our customer's lifting requirements.

Our Company values are:

Safety & Sustainability: Be safe every time & respect the environment

Ingenuity: Be inventive & resourceful, build & leverage our technical expertise

Customer Satisfaction: Meet customer's needs, Solve customer's problems

Accountability: Treat the business as if it's your own

Care: Help each other & customers to succeed

Integrity: Do the right thing



MANUAL HOIST

Hand Chain Block - LMCB

Load from 0.5 to 30 Ton

LMCB is a compact, high performance

Hand chain block, tested according to applicable Standards.

TECHNICAL FEATURES

- Machined chain sprocket and gears provide smoother more efficient operation.
- 3 meters/6 meters standard lift, Non – standard lift also available.
- High strength Gr.80 alloy steel load chain with black finish
- LMCB's compact design offers safety together with reduced weight, ideal for construction and maintenance applications
- Alloy steel components have specific heat treatment which avoids sudden break
- Steel casing solidly protects chain sprockets, gear case and hand wheel cover
- LMCB comes with automatic double pawl braking system
- High resistance industrial powder coating meets ROHS requirement
- 1500 cycles life test meets EN 13157, ANSI B30 16, AS1418 standards
- Factor of safety- 4:1
- Proof load – 1.5 WLL

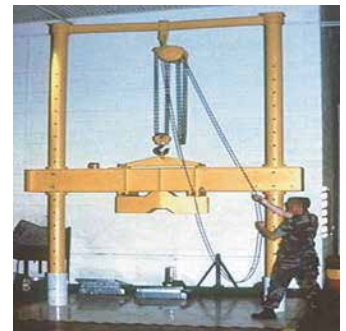

MANUAL HOIST

Hand Chain Block - LMCB

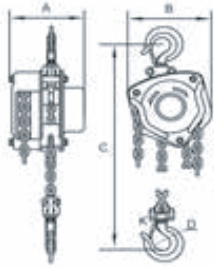

0.5-2T

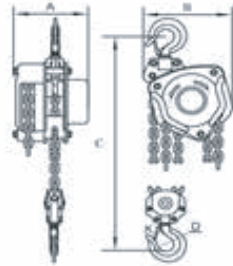

3T, 5T

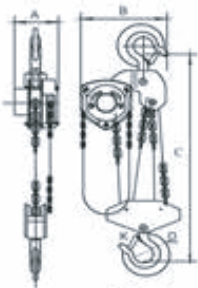

10T, 15T

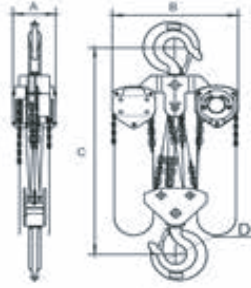

20T



Chain Block Specifications

Model No	Capacity (Kg)	Standard Lift (m)	Running Test Load (KN)	Effort Required to Lift (N)	Dia of Load Chain (mm)	No of Falls	Dimension					Net Weight (KG)	Extra Weight Per Meter of Extra lift (Kg)
							A	B	C	D	K		
LMCB-0.5	0.5	2.5	7.5	225	5	1	132	152	315	34	27	8.5	1.3
LMCB-1	1	2.5	15	300	6	1	152	157	355	38	27	11	1.6
LMCB-1.5	1.5	2.5	22.5	350	8	1	155	180	375	48	36	14.5	2.3
LMCB-2	2	3	30	310	8	1	185	207	430	48	36	17.5	2.3
LMCB-3	3	3	45	350	7.1	2	152	207	500	50	38	20.5	3.2
LMCB-3(a)	3	3	45	370	8	2	155	207	500	50	38	23	3.7
LMCB-5	5	3	75	400	9	2	185	267	680	57	48	36.5	4.5
LMCB-5(a)	5	3	75	415	10	2	189	267	680	57	48	39.5	5.3
LMCB-7.5	7.5	3	112.5	415	10	3	189	380	650	72	47	44	7.5
LMCB-10	10	3	150	410	9	4	185	380	750	80	51	60	8.1
LMCB-10(a)	10	3	150	415	10	4	189	380	750	80	51	65	9.7
LMCB-15	15	3	225	420	10	6	194	400	880	85	58	102	14
LMCB-20(a)	20	3	300	410*2	9	8	220	440	940	106	70	146	16.2
LMCB-20	20	3	300	410*2	10	8	224	440	940	106	70	156	19.3
LMCB-30	30	3	450	410*2	10	12	274	649	1100	120	80	246	28.2

LEVER HOIST

Lever Hoist - LMLH

Load from 0.25 to 9 Tons

The LMLH manual lever hoist is a compact unit

For lifting, pulling and sliding. Especially suitable for industrial use.

TECHNICAL FEATURES

- Choice of robust, compact, lightweight, easy handling units
- Standard chain lengths 1.5 mtrs and Non-standard chain length also available on request.
- LMLH can be used in any position, simply switch the lever to make the hoist easier to handle
- LMLH comes with asbestos Free Friction Disc
- LMLH comes with Automatic double pawl braking system
- Reinforced casing effectively protects mechanisms
- High resistance industrial powder coating meets ROHS requirement
- Extra safe, light weight and low maintenance
- High strength Gr 80 alloy load chain with black finish
- 1500 cycles life test meets ANSI B30-21, AS1418 standards
- Factor of safety – 4:1
- Proof Load – 1.5 WLL



LEVER HOIST

Lever Hoist - LMLH



LEVER HOIST SPECIFICATIONS

Model No	Capacity (Kg)	Standard Lift (m)	Running Test Load (KN)	Effort Required to Lift (N)	Dia of Load Chain (mm)	No of Falls	Dimension					Net Weight	Extra Weight Per Meter of Extra lift (Kg)
							A	B	C	H	L		
LMLH-0.25	0.25	1	3.75	250	4	1	92	72	85	230	160	1.8	0.41
LMLH-0.5	0.5	1.5	7.5	340	5	1	105	78	80	260	300	4	0.52
LMLH-0.75	0.75	1.5	11.2	140	6	1	153	86	130	295	315	7.5	0.8
LMLH-01	1	1.5	15	185	6	1	153	96	130	295	315	7.5	0.8
LMLH-1.5	1.5	1.5	22.5	230	7.1	1	166	100	150	335	365	9.5	1.1
LMLH-02	2	1.5	30	251	8	1	175	105	160	385	368	15.5	1.4
LMLH-03	3	1.5	45	285	10	1	195	112	202	450	365	16.5	2.2
LMLH-06	6	1.5	75	385	10	2	195	112	242	550	365	27	4.4
LMLH-09	9	1.5	135	390	10	3	195	112	312	660	365	40	6.6

WIRE ROPE PULLER

Model: LMRW

Loads from 0.8 to 5.4 Tons

Wire rope pullers are portable manual hoist used with wire rope. They can be used to lift, pull and position loads over great distances depending on the wire rope length. They are suitable for use in numerous configurations and the ideal solution for use in professional applications. They are operated by a simple lever option and the load capacity of the wire rope puller system can be increased by using

Technical Features

- Low weight – Quick installation
- Standard cable length – 20 Mtrs, Non standard
- Cable length also available
- Manageable, Robust and Powerful
- Increase load capacity with deflection sheaves
- Overload protection
- Precise load placement within millimeters

No wheels or Gears Required

- Two jaws alternately pull the wire rope and the load in the required direction, just like pulling on a rope with both hands
- The jaws are self-clamping, providing immediate and gradual safety
- The heavier the load, the tighter they clamp

Safety and Reliable

- Constant control of the load during lifting and lowering with accuracy to within one millimeter
- When stationary, the load is automatically distributed between the two jaw units
- Overload safety device

Multifunction

- Work can be performed in any position; horizontal, vertical or at an angle
- There is no limit to the length of wire rope

Increased Capacity

- Using the sheave block technique, the capacity of the Wire rope puller can be increased by a factor of 2, 3, 4 or more

WIRE ROPE PULLER

Model: LMRW

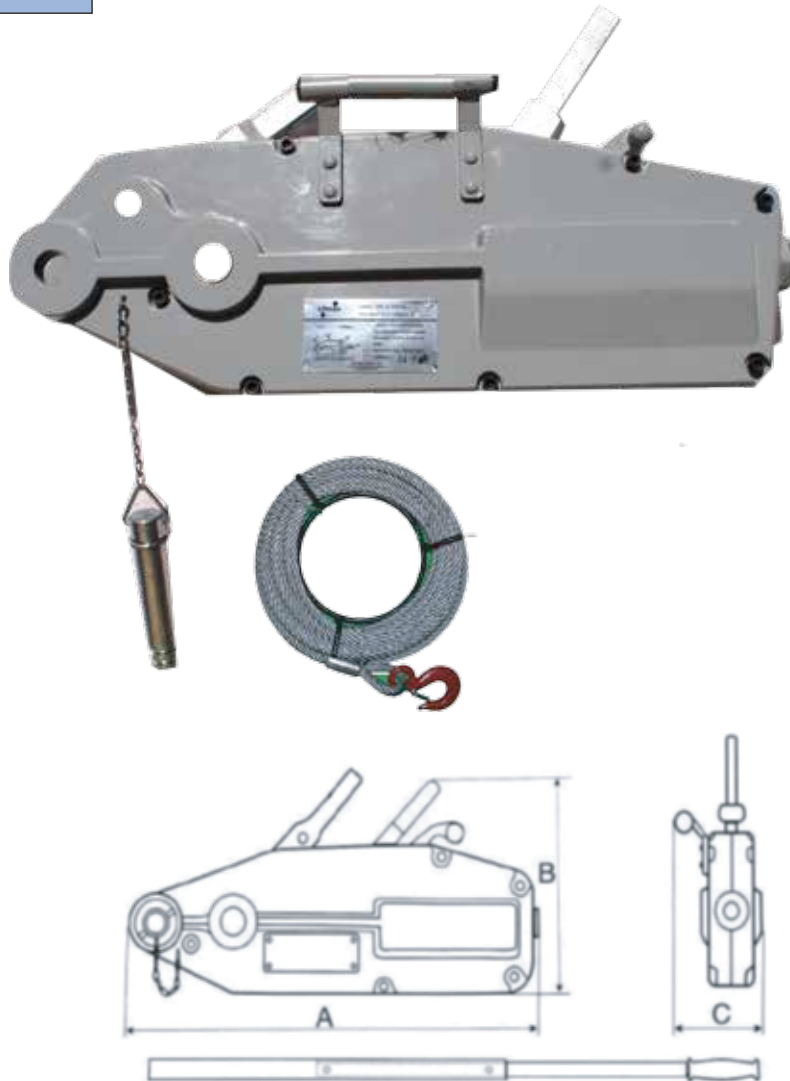

WIRE ROPE PULLER SPECIFICATIONS

Model	Rated Capacity (Tons)	Pulling Capacity (Tons)	Rated Forward Travel (mm)	Efficient Length of forward handle (mm)	Rope Dia (mm)	Standard Length of Rope	Net Weight (Kg)	Rated forward Hand power (N)	Max overall size (mm)
LMRW-0.8	0.8	1.2	≥52	825	8.3	20	16	≤341	426x238x64
LMRW-1.6	1.6	2.4	≥55	1200	11	20	24	≤400	545x284x97
LMRW-3.2	3.2	4.8	≥28	1200	16	20	32	≤438	660x325x98
LMRW-5.4	5.4	8.1	≥25	1200	20	20	90	≤550	930x390x150

LEVER TYPE LOAD BINDER

Model: LMLB(L)

Technical Features

- Safety, Durability designed for all heavy duty transport use.
- Drop forged steel high strength with heavy duty grab hooks
- Free 360 degree swivel hooks for easier handling
- Heat treated for extra strength
- Each binder individually proof tested

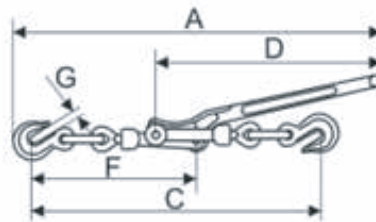
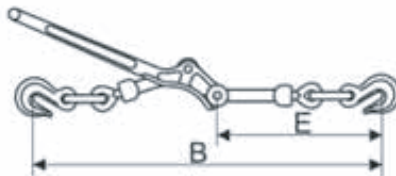

LEVER TYPE LOADBINDER SPECIFICATION

Model	Chain size (in)	WLL (Ton)	Proof Load (Ton)	Min Ultimate Load (Ton)	Wt (Kg)	Handle (in)	Dimension(in)						
							A	B	C	E	E1	F	F1
LMLB(L-02)	1/4"- 5/16"	1.3	2.6	3.9	1.62	11.42	18.5	17.3	14.1	11.4	8.27	8.07	0.35
LMLB(L-05)	5/16"-3/8"	2.7	5.4	9.5	3.8	15.43	25.2	23.2	19.4	15.5	11.2	11.2	0.51
LMLB(L-09)	3/8"-1/2"	4.6	9.2	14	5.5	17.24	28.5	26.3	22.05	17.6	12.99	12.2	0.59
LMLB(L-11)	1/2"- 5/8"	5.5	11	22	8.9	21	33.8	30.1	25.78	20.87	14.37	14.3	0.74

RATCHET TYPE LOAD BINDER

Model: LMLB(R)

Technical Features

- Safety, reliable design for easy operation
- Designed for heavy duty transport use
- High quality drop forged and heat treated for extra strength
- Each binder individually proof tested

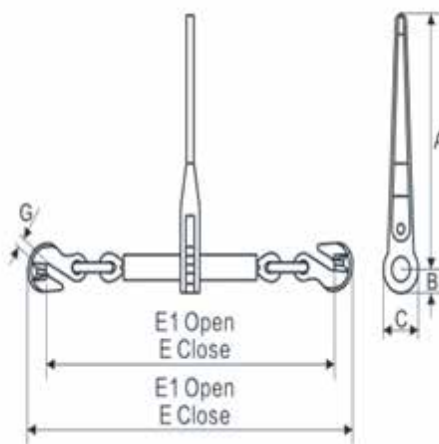

RATCHET TYPE LOADBINDER SPECIFICATION

Model	Chain size (in)	WLL (Tons)	Proof Load (Tons)	Min Ultimate Load (Tons)	Wt Kg	Handle Length (in)	Dimension(in)						
							A	B	C	E	E1	F	F1
LMLB(R-02)	1/4" - 5/16"	1.3	2.6	3.9	1.6	7.16	7.16	0.89	1.77	16.2	21.2	17.7	22.8
LMLB(R-05)	5/16" - 3/8"	2.7	5.4	9.5	4.75	13.42	13.9	1.3	2.6	22.6	30.6	25.2	33.2
LMLB(R-09)	3/8" - 1/2"	4.6	9.2	16.5	5.85	13.92	13.9	1.3	2.6	24.1	32.1	27	35
LMLB(R-11)	1/2" - 5/8"	5.5	11	23	6.52	13.92	13.9	1.3	2.6	26.4	34.4	30	38

CHAIN SLING

Model: LIFTMAN Chain Sling

Technical Features

- The range consists of chain sizes from 6mm through to 32mm offering lifting capacities of up to 67 tons (32mm 4 leg slings at 0-45° working angle)
- A wide range of terminal fitting options are available in all sizes including clevis self-locking hooks, clevis sling hooks, grab hooks, shortening clutches etc.
- Each chain sling is fitted with an identification tag that displays the WLL of the sling and an individual serial number
- All slings are supplied with the Certificate of conformity
- Liftman chains slings meets the standard of EN818-4

Chain Sling Specifications

Factor of safety		Single leg chains		2 leg chains				3 and 4 leg chains		Endless chains	Basket chains	
4												
	Working angles	-	-	0° - 45°	45° - 60°	0° - 45°	45° - 60°	0° - 45°	45° - 60°	-	0° - 45°	0° - 45°
	Load factor	1	0.8	1.4	1	1.12	0.8	2.1	1.5	1.6	1.4	2.1
Grade	Dia.	Working load limits (tonnes)										
8	6mm	1.12	0.90	1.60	1.12	1.25	0.90	2.36	1.70	1.80	1.60	2.36
8	7mm	1.50	1.20	2.12	1.50	1.68	1.20	3.15	2.24	2.50	2.12	3.15
8	8mm	2.00	1.60	2.80	2.00	2.24	1.60	4.25	3.00	3.15	2.80	4.25
8	10mm	3.15	2.50	4.25	3.15	3.55	2.50	6.70	4.75	5.00	4.25	6.70
8	13mm	5.30	4.25	7.50	5.30	5.90	4.25	11.20	8.00	8.50	7.50	11.20
8	16mm	8.00	6.30	11.20	8.00	9.00	6.30	17.00	11.80	12.50	11.20	17.00
8	20mm	12.50	10.00	17.00	12.50	14.00	10.00	26.50	19.00	20.00	17.00	26.50
8	22mm	15.00	12.00	21.20	15.00	16.80	12.00	31.50	22.40	24.00	21.20	31.50
8	26mm	21.20	16.95	30.00	21.20	23.70	16.95	45.00	31.50	33.50	30.00	45.00
8	32mm	31.50	25.20	45.00	31.50	35.20	25.20	67.00	47.50	50.00	45.00	67.00

G-80 LIFTING CHAIN

Model: LMCH

Technical Features

- High quality alloy steel chain
- Surface finish: self-color, black finish
- Proof load: 200% WLL
- Factor of safety is 4:1
- Confirming to standard EN 818-2

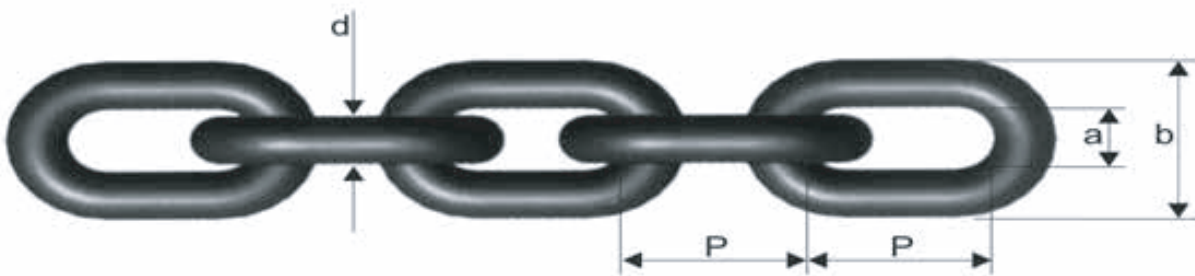

G-80 LIFTING CHAIN SPECIFICATION

Part No	Size (mm)	Width(mm)		WLL (Tons)	Test Load KN	Min Breaking Load KN	Weight Kg/m
		Inside min(a)	Outside max(b)				
LMCH-06	6X18	7.5	21	1.1	27	45.2	0.79
LMCH-08	8X24	10	28	2	48	80.4	1.38
LMCH-10	10X30	12.5	35	3.2	76	125	2.2
LMCH-13	13X39	16.3	46	5.4	128	214	3.8
LMCH-16	16X48	20	56	8.2	192	320	5.63
LMCH-16	16X49	24.5	59.5	8.2	192	320	5.71
LMCH-16	16X64	23.9	58.9	8.2	192	320	5.11
LMCH-18	18X54	23	63	10	246	410	6.85
LMCH-18	18X64	21	60	10	246	410	6.6
LMCH-20	20X60	25	70	12.8	300	450	8.6
LMCH-22	22X65	28	74.2	15.4	366	610	10.7
LMCH-22	22X66	28	77	15.4	366	610	10.2
LMCH-22	22X86	26	74	15.4	366	610	9.5
LMCH-26	26X78	35	91	21.6	510	850	14.87
LMCH-26	26X92	30	86	21.6	510	850	13.7
LMCH-32	32X96	40	106	32.7	772	1286	22.29

MASTER LINK

Model: LMML

Technical Features

- Forged or welded super alloy steel
- Suitable for use with Gr.80 chain
- Meets standard EN 1677
- Used for 1 or 2 legs wire rope/chain slings
- Individually proof tested at 2.5 times of the working load limit
- Factor of safety is 4:1

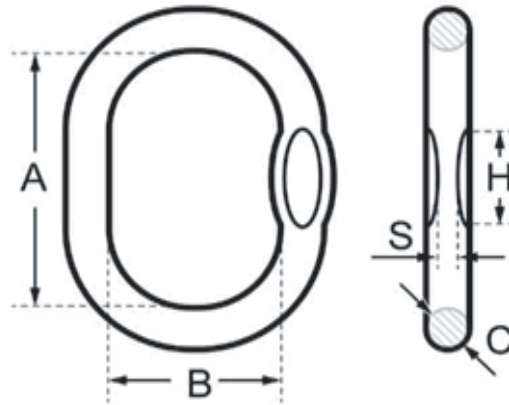

Master Link Specifications

Model No	Weight (kg)	WLL(Ton)	A	B	C	S	H
LMML-13B5	0.3	2.6	95	51	13	7	50
LMML-13B6	0.35	2.4	115	60	13	7	50
LMML-16B6	0.6	3.8	120	70	16	9	70
LMML-16B7	0.86	2.8	190	100	16	9	70
LMML-20B6	1.1	6.4	150	80	20	11	50
LMML-20B7	1.25	5.8	170	90	20	11	70
LMML-22B6	1.53	7.6	170	90	22	12	70
LMML-22B7	1.83	6.4	210	110	22	12	70
LMML-25B6	2.21	10	190	100	25	13	80
LMML-28B6	3.06	12.7	210	110	28	15	80
LMML-28B7	3.81	10.5	270	140	28	15	70
LMML-32B6	5.05	15.2	270	140	32	17	70
LMML-38B6	7.3	25.1	270	140	38	20	55
LMML-38B7	10.78	17	420	220	38	20	55
LMML-45B6	12.2	34	320	170	45	24	60
LMML-45B7	17.06	24.5	470	250	45	24	60
LMML-50B6	17.65	40	380	200	50	-	-
LMML-60B6	28.85	58	430	220	60	-	-
LMML-70B6	45.48	84	500	250	70	-	-

MASTER LINK ASSEMBLY

Model: LMMA

Technical Features

- Forged or welded super alloy steel
- Suitable for use with Gr.80 chain
- Meets standard EN 1677
- Uses for 3 or 4 legs wire rope/chain slings
- Individually proof tested at 2.5 times working load limit
- Factor of safety is 4:1

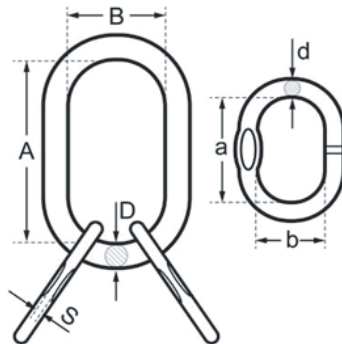

Master Link Specifications

Model No	Weight (kg)	WLL(Ton)	A	B	D	a	b	d
LMMA-16	1.19	3.8	120	70	16	95	51	13
LMMA-20	2.41	5.8	170	90	20	120	70	16
LMMA-22	3.77	7.6	170	90	22	150	80	20
LMMA-25	4.45	10	190	100	25	150	80	20
LMMA-28	6.12	12.7	210	110	28	170	90	22
LMMA-32	9.47	15.2	270	140	32	190	100	25
LMMA-38	17.4	25	270	140	38	270	140	32
LMMA-45	26.76	34	320	170	45	270	140	38

CONNECTING LINK

Model: LMCL

Technical Features

- Used to connect chain to master links, hooks and other components
- It is easily assemble and can be disconnected if required
- Forged or welded super alloy steel
- Suitable for use with Gr.80 chain
- Meets standard EN 1677
- Individually proof tested at 2.5 times working load limit
- Factor of safety is 4:1

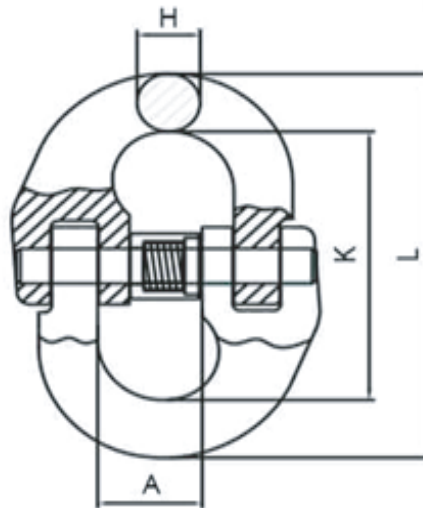

Connecting Link Specifications

Model No	Dia of Chain (mm)	Weight (Kg)	WLL(Tons)	A	L	K	H
LMCL-07	07	0.286	1.5	16.5	67	51	8
LMCL-09	09	0.32	2.0	17	78.5	58.5	10
LMCL-10	10	0.73	3.2	22	87.6	63.6	12
LMCL-13	13.5	1.67	5.4	28.5	115.5	85.5	15
LMCL-16	16	2.86	8.2	33	143	106	18.5
LMCL-19	19	5.00	12.8	41	162	116	23
LMCL-22	22	7.50	15.5	50.5	188.5	136.5	26
LMCL-25	25	11.03	21.6	57	214.5	152.5	31
LMCL-32	32	20.38	32.7	65	265	188.7	38

CLEVIS SHORTENING CLUTCH

Model: LMSC

Technical Features

- Forged super alloy steel – Quenched & Tempered
- Suitable for use with Gr.80 chain
- Meets standard EN 818-2
- Individually proof tested at 2.5 times workingload limit
- Factor of safety is 4:1
- 100% Magnaflux crack detection

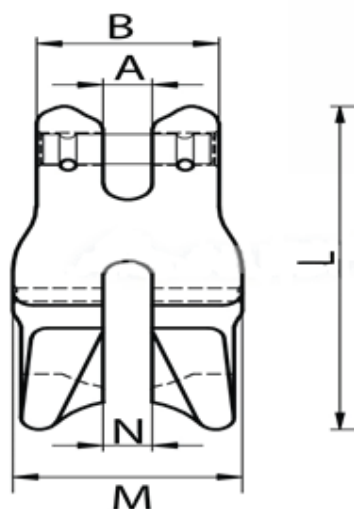

Clevis Shortening Clutch Specification

Model No	WLL (Tons)	N (mm)	A (mm)	M (mm)	B (mm)	L (mm)	Net Wt (Kg)
LMSC-08	2	9.5	9.5	45	36	101	0.37
LMSC-10	3.15	13	13	55	48	138	0.97
LMSC-13	5.3	16	16	75	59	177	2.01
LMSC-16	8	21	21	93	73	220	3.32
LMSC-20	12.5	22	22	99	78	238	6.2
LMSC-22	15	25.5	25.5	118	98	295	8.5

CLEVIS SLING HOOK WITH LATCH

Model: LM-CSH

Technical Features

- Forged super alloy steel – Quenched & Tempered
- Fatigue tested at 1.5 times the WLL for 2000 cycles
- Designed to use for Gr.80 alloy steel chain
- Meets standard EN 818-2
- Individually proof tested at 2.5 times working load limit
- Factor of safety is 4:1
- 100% Magnaflux crack detection

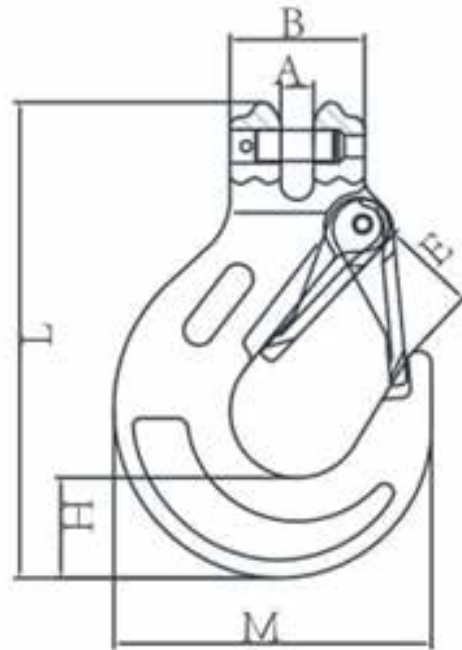

Clevis Sling Hook with Latch Specifications

Model No	WLL (Tons)	A (mm)	B (mm)	H (mm)	E (mm)	L (mm)	Net Wt (Kg)
LM-CSH(08)	2	9.5	37	32	29	118	0.52
LM-CSH(10)	3.15	13	50	35	39	139	1.05
LM-CSH(13)	5.3	16.5	56	43	47	170	2
LM-CSH(16)	8	21.5	70	54	55	204	3.7
LM-CSH(20)	12.5	24	75	58	61	238	6
LM-CSH(22)	15	27	91	62	72	275	10.4
LM-CSH(26)	21.2	30	118	74	85	325	14.5
LM-CSH(32)	31.5	55	149	86	106	405	27

EYE SLING HOOK WITH LATCH

Model: LM-ESH

Technical Features

- Forged super alloy steel – Quenched & Tempered
- Fatigue tested at 1.5 times the WLL for 2000 cycles
- Designed to use for Gr.80 alloy steel chain
- Meets standard EN 818-2
- Individually proof tested at 2.5 times working load limit
- Factor of safety is 4:1
- 100% Magnaflux crack detection

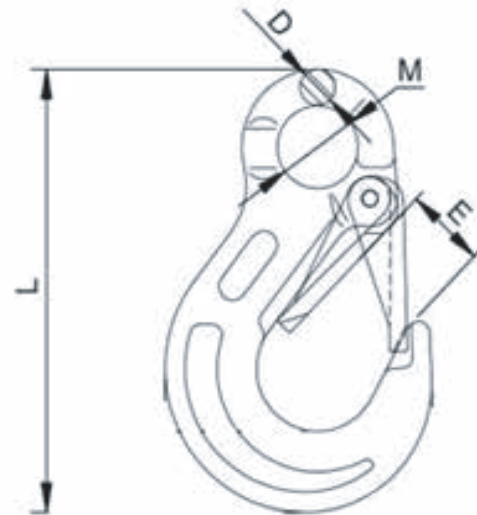

Clevis Sling Hook with Latch Specifications

Model No	WLL (Tons)	M (mm)	D (mm)	E (mm)	L (mm)	(Kg)
LM-ESH(08)	2	25	11	30	132	0.55
LM-ESH(10)	3.15	38	16	33	165	1.05
LM-ESH(13)	5.3	42	19	40	210	1.75
LM-ESH(16)	8	49	22	43	254	3.2
LM-ESH(20)	12.5	61	26	39	304	5.3
LM-ESH(22)	15	61	31	72	347	9.0
LM-ESH(26)	21.2	65	36	81	390	13
LM-ESH(32)	31.5	88	38	102	480	17

CLEVIS SELF LOCKING HOOK

Model: LMCG8

Technical Features

- Forged or welded super alloy steel
- Fatigue tested at 1.5 times the WLL for 2000 cycles
- Suitable for use with Gr.80 alloy steel chain
- Meets standard EN 1667
- All clevis self-locking hook are Individually proof tested at 2.5 times working load limit
- Factor of safety is 4:1
- 100% Magnaflux crack detection

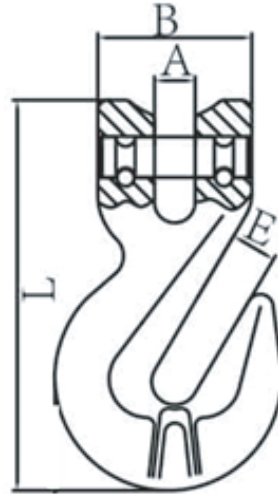

Clevis Self Locking Hook Specifications

Model No	WLL (Tons)	A (mm)	E (mm)	B (mm)	L (mm)	Net Wt (Kg)
LMCG8-06	1.2	8	8	34	90.5	0.22
LMCG8-07	2	9.5	9.5	41	106.5	0.31
LMCG8-10	3.2	12.7	12.5	46	137	0.7
LMCG8-13	5.4	16	16.7	61	185	1.8
LMCG8-16	8.2	19.5	20	68	215	3.1
LMCG8-20	12.8	24	24	88	254	4.1
LMCG8-22	15.5	27	26	96	295	6.2

EYE GRAB HOOK

Model: LMEG8

Technical Features

- Forged or welded super alloy steel
- Fatigue tested at 1.5 times the WLL for 2000 cycles
- Suitable for use with Gr.80 alloy steel chain
- Meets standard EN 1667
- All clevis self-locking hook are Individually proof tested at 2.5 times working load limit
- Factor of safety is 4:1
- 100% Magnaflux crack detection

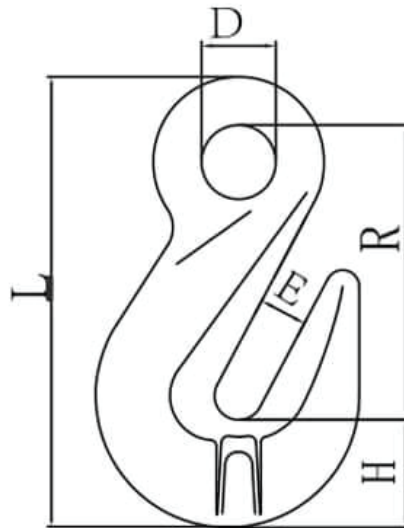

Clevis Grab Hook Specifications

Model No	WLL (Tons)	E (mm)	D (mm)	H (mm)	R (mm)	L (mm)	Net Wt (Kg)
LMEG8-06	1.2	8	13	19	54	81	0.22
LMEG8-08	2	9.5	15	23	64	98	0.31
LMEG8-10	3.2	12.5	20	30	82	125	0.7
LMEG8-13	5.4	17	25	42	106	165	1.8
LMEG8-16	8.2	20	30	49	127	196	3.1
LMEG8-20	12.8	23	34.5	56	152	231	4.1
LMEG8-22	15.5	28	40.5	65	175	257	6.2

CLEVIS GRAB HOOK Gr.70

Model: LMCG7

Technical Features

- Forged alloy steel or carbon steel
- Quenched and tempered
- Suitable for use with Gr.70 alloy steel chain
- Not for lifting, only for lashing or pulling
- Ultimate load is 4 times the working load limit

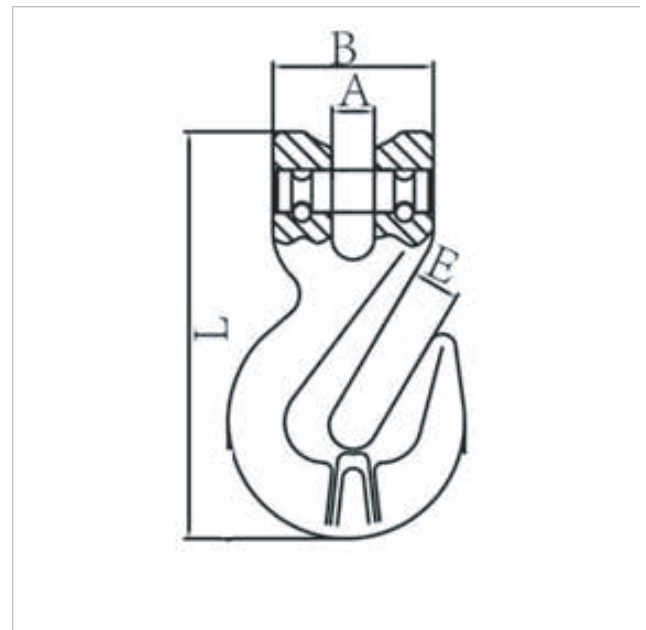

Clevis Grab Hook Specifications

Model No	WLL (Tons)	A (mm)	B (mm)	E (mm)	L (mm)	Net Wt (Kg)
LMCG7-06	1	8.5	25	9.2	78	0.16
LMCG7-08	2	10	30	11	93	0.28
LMCG7-10	3	13	35	12.7	114.5	0.45
LMCG7-13	5	19	47	17	144	1.0
LMCG7-16	7.1	23	56	20	177	2.0
LMCG7-20	11.2	24	66	24	207.5	3.0

EYE GRAB HOOK Gr.70

Model: LMEG7

Technical Features

- Forged alloy steel or carbon steel
- Quenched and tempered
- Suitable for use with Gr.70 alloy steel chain
- Not for lifting, only for lashing or pulling
- Ultimate load is 4 times the working load limit

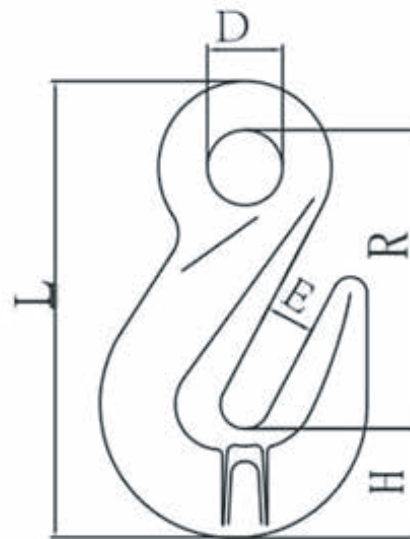

Eye Grab Hook Specifications

Model No	WLL (Tons)	R (mm)	H (mm)	D (mm)	E (mm)	L (mm)	Net Wt (Kg)
LMEG7-06	1	50.5	18.5	13	9	77	0.12
LMEG7-08	2	56.8	22.7	14	11.5	89	0.20
LMEG7-10	3	65.2	28.3	17	13	104	0.35
LMEG7-13	5	85.5	37.5	22	17	135	0.80
LMEG7-16	7.1	116	45	30	21	180	1.50
LMEG7-20	11.2	133	55	35	25	211	2.70

BEAM CLAMP

Model: LMBC

Technical Features

- Flexible application due to wide adjustment range
- Gives quick and versatile rigging for hoisting equipment, pulley blocks or loads
- The central threaded spindle allows easy attachment and a safe secure grip.
- Spindle can be secured against loosening.

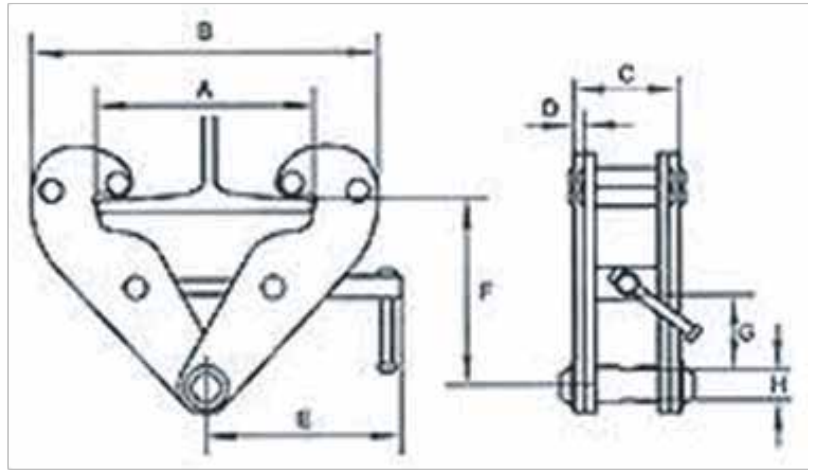

Beam Clamp Specifications

Model No	WLL (Tons)	Jaw Opening (mm)	A		B		C (mm)	D (mm)	E (mm)	F		G		H (mm)
			Min (mm)	Max (mm)	Min (mm)	Max (mm)				Min (mm)	Max (mm)	Min (mm)	Max (mm)	
LMBC-01	01	75-220	70	300	165	385	67	4	230	70	160	16	70	22
LMBC-02	02	75-220	70	300	165	385	75	6	230	70	160	16	70	22
LMBC-03	03	80-320	70	388	230	508	100	8	265	130	230	32	110	25
LMBC-05	05	80-320	70	388	230	508	108	10	265	130	230	32	110	25
LMBC-10	10	90-320	82	440	270	590	117	12	325	170	275	60	135	35
LMBC-20	20	90-320	105	485	385	710	135	16	365	220	330	70	170	54

VERTICAL PLATE LIFTING CLAMP

Model: LM-HPL

Technical Features

- The clamp is fitted with a locking device for both open and closed positions, which ensures complete safety.
- For lifting and transporting of thick steel plates.
- The clamp is locked in closed as well as in open position.
- The working load is the capacity of the one piece. It may be used single or pairs of clamp used together.
- Made of high-quality carbon steel



Vertical Plate Lifting Clamp Specifications

Model No	WLL (Tons)	Jaw opening (mm)	Weight (Kg)
LM-VPL(08)	0.8	15-30	2
LM-VPL(16)	1.6	20-40	7
LM-VPL(32)	3.2	25-50	15
LM-VPL(45)	4.5	25-50	15
LM-VPL(50)	5.0	36-60	23

HORIZONTAL PLATE LIFTING CLAMP

Model: LM-HPL

Technical Features

- It can be used for lifting and transport of steel plates, construction and profiled bar in horizontal position.
- It avoids snatch or shock loading.
- The working load limit is the maximum load that the clamps are authorized to support when used in pairs with a lift angle of 60°.
- In lifting operations the clamps can be used in pairs or multiples.
- Made of high-quality carbon steel

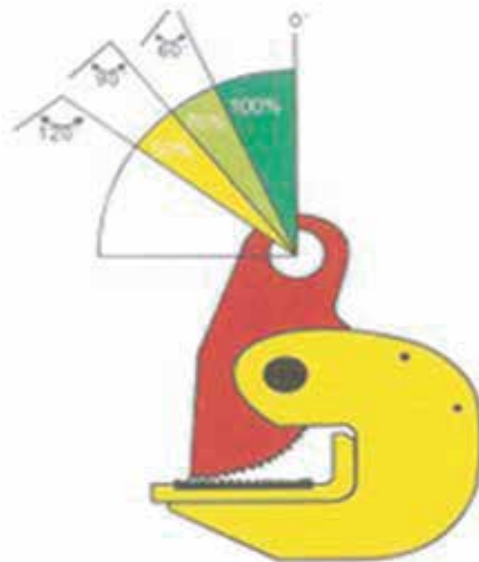

Horizontal Plate Lifting Clamp Specifications

Model No	WLL (Tons)	Jaw opening (mm)	Weight (Kg)
LM-HPL(01)	1	0-30	4
LM-HPL(02)	2	0-50	5.5
LM-HPL(32)	3.2	0-60	8
LM-HPL(05)	5	10-80	11.5
LM-HPL(06)	6	10-100	14.5
LM-HPL(10)	10	20-120	30

PIPE LIFTING CLAMP

Model: LM-PLC

Technical Features

- This comes with compact shapes and relatively low on weight with a high lifting capacity.
- The surface of the lifting clamp equipped with special plastic surface
- The plastic cover can be changed
- This can be used for horizontal lifting and transportation of steel and concrete pipes
- These clamps should always be used in pairs.

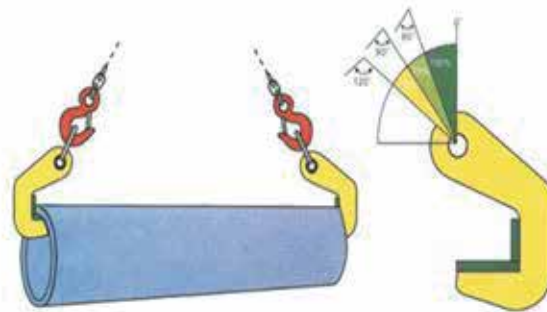

Pipe Lifting Clamp Specifications

Model No	WLL (Tons)	Jaw opening (mm)	Weight (Kg)
LM-PLC(015)	1.5	40	1.5
LM-PLC(03)	3.0	40	2
LM-PLC(04)	4.0	50	2.8
LM-PLC(06)	6.0	50	3.2
LM-PLC(08)	8.0	70	5
LM-PLC(10)	10.0	70	9.7
LM-PLC(12)	12.0	70	13
LM-PLC(16)	16.0	70	15.8
LM-PLC(18)	18.0	70	22

PERMANENT TYPE MAGNETIC LIFTER

Model: LM-PML

Technical Features

This permanent magnets operate independently of a power supply. Due to the specific arrangement of a group of permanent magnets, the magnet field lines act on the magnet pole and the load, or are deflected in the magnet housing so that the poles are not magnetized. In position "ON", the magnetic field lines are guided via the poles through the load. The magnet is active. In position "OFF", the magnet pole surfaces are neutral and the magnet is therefore switched off. The load lifting magnet consists of individual standardized components. The inside of the magnet comprises the actual magnet system consisting of a reversing magnet system, the magnet assembly and the magnet poles.

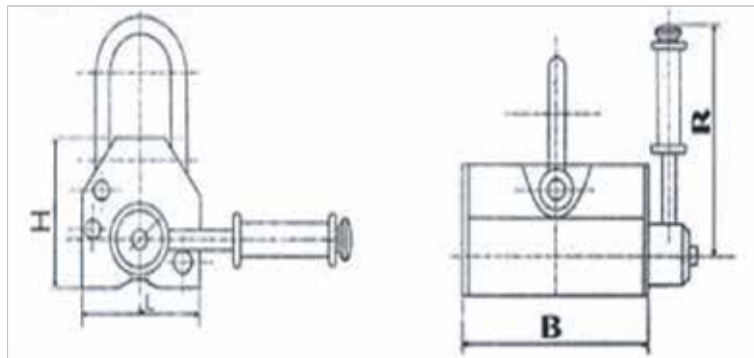

Permanent type Magnetic Lifter Specifications

Model No	WLL (Kg)	Cylindrical Lifting Capacity (Kg)	Max Pull-off Strength (Kg)	N.W/KGS	L (mm)	B (mm)	H (mm)	R (mm)
LM-PML(01)	100	30	350	3	62	92	70	145
LM-PML(03)	300	100	1050	10	92	162	96	180
LM-PML(05)	500	150	1750	20	120	216	118	220
LM-PML(06)	600	200	2100	24	122	232	120	220
LM-PML(10)	1000	300	3500	50	176	258	163	285
LM-PML(20)	2000	600	7000	125	234	378	212	465
LM-PML(30)	3000	1000	10500	220	286	458	261	565

CARGO LASHING BELT

Model: LM-CLB

Technical Features

- 100% High tenacity of polyester lashing strap
- Low elongation
- Width available : 1" – 4"
- Standard length : 10 mtrs and also can be customized on requirement
- Breaking strength scope : 1T – 10T
- Meets standard EN 12195-2
- End fittings – Double J Hook, Fasteners - Ratchet



Cargo lashing belt Specifications

Model No	M.B.S (Tons)	Webbing width (inch)	Breaking Load (Tons)	Lashing capacity (Tons)
LM-CLB(01)	1	1"	1.2	0.5
LM-CLB(04)	4	2"	5.0	2.0
LM-CLB(08)	8	3"	9.2	4.0
LM-CLB(10)	10	4"	12.5	5.0

PLAIN TROLLEY

Model: LMPT

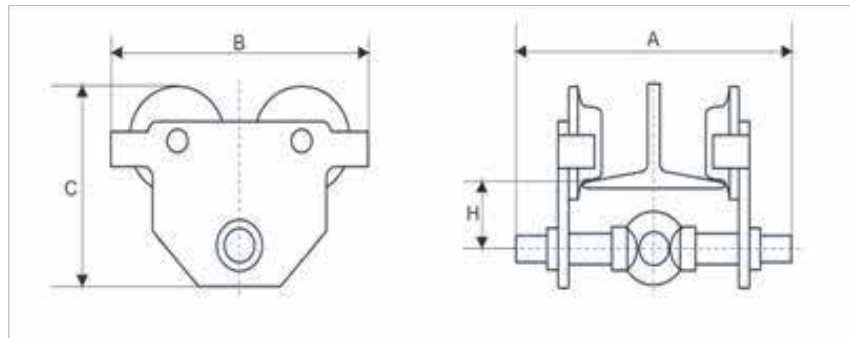

Model No	WLL (Tons)	I-Beam Width (mm)	Min turning Radius (m)	N.W/KGS	A (mm)	B (mm)	C (mm)	H (mm)
LMPT-50	0.5	50-220	0.9	5.5	290	212	166	67
LMPT-01	1	58-220	1.0	8.7	300	238	189	74
LMPT-02	2	66-220	1.1	14.6	300	277	220	92
LMPT-03	3	74-220	1.3	24.5	321	330	283	119
LMPT-05	5	90-220	1.4	34.5	415	346	305	126

GEARED TROLLEY

Model: LMGT

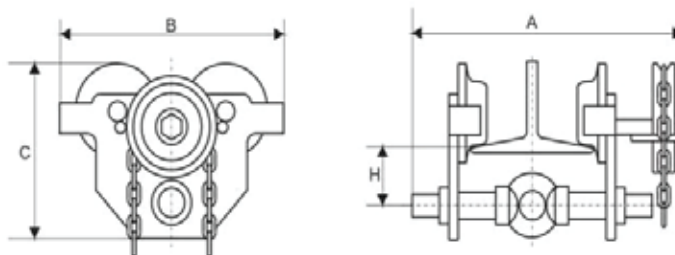

Model No	WLL (Tons)	I-Beam width (mm)	Min turning radius (m)	N.W/KGS	A (mm)	B (mm)	C (mm)	H (mm)
LMGT-50	0.5	50-220	0.9	9	352.5	212	166	67
LMGT-01	1	58-220	1.0	12.6	353.5	238	189	74
LMGT-02	2	66-220	1.1	18.5	355	270	220	92
LMGT-03	3	74-220	1.3	30	400	330	283	119
LMGT-05	5	90-220	1.4	41	420	346	305	126

OUR LOCATION:

**LIFTMAN UK PVT LTD
H5, ASH TREE COURT, NOTTINGHAM
BUSINESS PARK NOTTINGHAM NG8
6PY, ENGLAND**